

SCB/MSCB Bypass Framing Slide-Clip Connectors

The SCB/MSCB slide-clip connectors are high-performance connectors for bypass framing applications designed to reduce design time and overall installed cost. Various anchorage methods have been tested, and the resulting allowable loads eliminate the need to design connector anchorage. The SCB/MSCB can accommodate applications that typically require two parts with a single connector, reducing material and labor cost. These connectors are manufactured in five different lengths to accommodate a variety of stand-off conditions and steel-stud sizes.

Features:

- Provides a full 1" of both upward and downward movement
- The precision-manufactured shouldered screws provided with the SCB/MSCB connector are designed to prevent overdriving and to ensure the clip functions properly
- Strategically placed stiffeners, embossments and anchor holes maximize connector performance
- Simpson Strong-Tie® "No-Equal" stamps mark the center of the slots to help ensure correct shouldered-screw placement

Material: SCB – 54 mil (16 ga.); MSCB – 68 mil (14 ga.)

Finish: Galvanized (G90)

Codes: IAPMO ER-238

Load Tables: Visit strongtie.com for the latest load tables and testing information

Ordering Information

SCB43.5-KT contains:

- 25 connectors
- (55) #14 shouldered screws

SCB45.5-KT, MSCB45.5-KT, SCB47.5-KT, MSCB47.5-KT, SCB49.5-KT, and SCB411.5-KT contain:

- 25 connectors
- (83) #14 shouldered screws

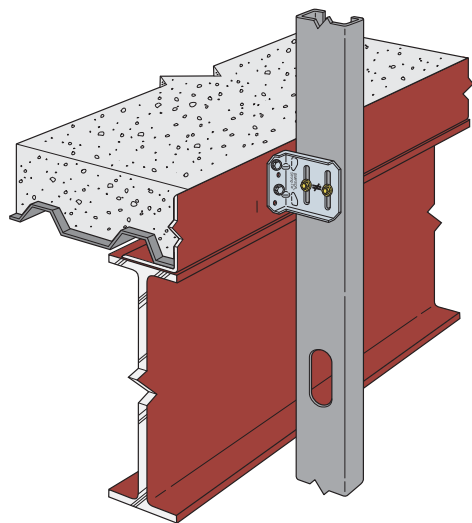

Typical SCB/MSCB Installation

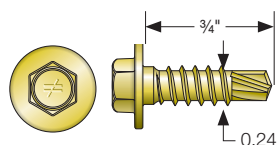

#14 Shouldered Screw

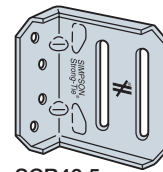

SCB43.5

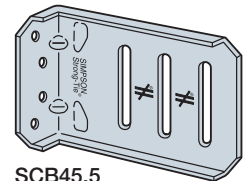

SCB45.5
(MSCB45.5 similar)

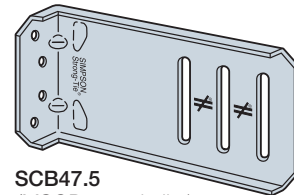

SCB47.5
(MSCB47.5 similar)

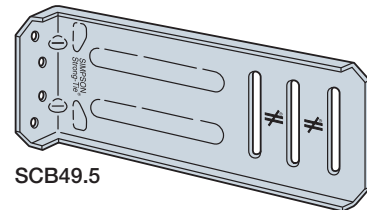

SCB49.5

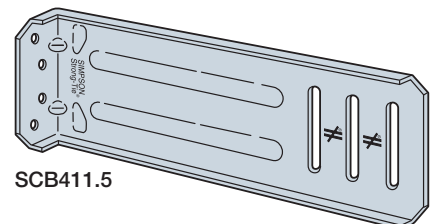

SCB411.5

U.S. Patent 8,555,592