

BXUV.W440 - Fire-resistance Ratings - ANSI/UL 263

Design/System/Construction/Assembly Usage Disclaimer

- Authorities Having Jurisdiction should be consulted in all cases as to the particular requirements covering the installation and use of UL Certified products, equipment, system, devices, and materials.
- Authorities Having Jurisdiction should be consulted before construction.
- Fire resistance assemblies and products are developed by the design submitter and have been investigated by UL for compliance with applicable requirements. The published information cannot always address every construction nuance encountered in the field.
- When field issues arise, it is recommended the first contact for assistance be the technical service staff provided by the product manufacturer noted for the design. Users of fire resistance assemblies are advised to consult the general Guide Information for each product category and each group of assemblies. The Guide Information includes specifics concerning alternate materials and alternate methods of construction.
- Only products which bear UL's Mark are considered Certified.

Fire-resistance Ratings - ANSI/UL 263

BXUV - Fire Resistance Ratings - ANSI/UL 263 Certified for United States

BXUV7 - Fire Resistance Ratings - CAN/ULC-S101 Certified for Canada

[See General Information for Fire-resistance Ratings - ANSI/UL 263 Certified for United States Design Criteria and Allowable Variances](#)

[See General Information for Fire Resistance Ratings - CAN/ULC-S101 Certified for Canada Design Criteria and Allowable Variances](#)

Design No. **W440**

May 25, 2022

Nonbearing Wall Ratings — 1, 2, 3 or 4 Hr (See items 4 and 4A)
 * Indicates such products shall bear the UL or cUL Certification Mark for jurisdictions employing the UL or cUL Certification (such as Canada), respectively.

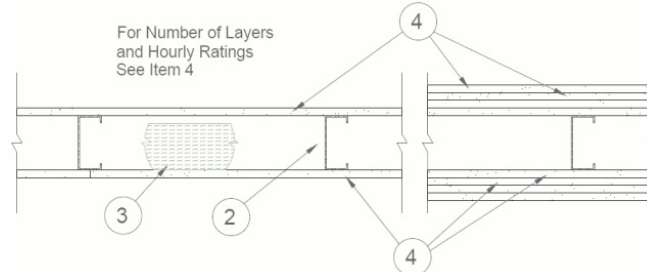

1. **Floor and Ceiling Runners** — (Not Shown) — For Use with Item 2 — Channel shaped, fabricated from min 25 MSG corrosion-protected steel, min depth as shown in item 4, attached to floor and ceiling with fasteners 24 in. OC max.

1A. **Floor and Ceiling Runners** — (Not Shown — Alternate to Item 1) — For use with Item 2A - Channel shaped, fabricated from min 20 MSG corrosion-protected or galv steel, min depth to accommodate stud size, with min 1 in. long legs, attached to floor and ceiling with fasteners spaced max 24 in. OC.

1B. **Framing Members* — Floor and Ceiling Runner** — (Not Shown — Alternate to Item 1) — For use with Item 2B, proprietary channel shaped runners, fabricated from 0.018 in. (bare metal thickness) attached to floor and ceiling with fasteners 24 in. OC max.
CALIFORNIA EXPANDED METAL PRODUCTS CO — Viper20™ Track, Viper X Track

IMPERIAL MANUFACTURING GROUP INC — Viper20™ Track

MARINO/WARE, DIV OF WARE INDUSTRIES INC — Viper20™ Track

RESCUE METAL FRAMING, L L C — AlphaTRAK

SCAFCO STEEL STUD MANUFACTURING CO — Type SUPREME D24/30EQD and Type SUPREME D20

STUDCO BUILDING SYSTEMS — CROCSTUD Track

STUDCO BUILDING SYSTEMS — CROCSTUD

1C. **Framing Members* — Floor and Ceiling Runner** — (Not Shown — Alternate to Item 1) — For use with Item 2C, proprietary channel shaped runners, fabricated from 0.015 in. (bare metal thickness) attached to floor and ceiling with fasteners 24 in. OC max.

CALIFORNIA EXPANDED METAL PRODUCTS CO — Viper25™ Track

CLARKDIETRICH BUILDING SYSTEMS — CD ProTRAK

CRACO MFG INC — SmartTrack25™

DMFCWBS L L C — ProTRAK

IMPERIAL MANUFACTURING GROUP INC — Viper25™ Track

MARINO/WARE, DIV OF WARE INDUSTRIES INC — Viper25™ Track

SUPER STUD BUILDING PRODUCTS — The Edge

TELLING INDUSTRIES L L C — TRUE-TRACK™

2. **Steel Studs** — Channel shaped, fabricated from min 25 MSG corrosion-protected steel, 1-1/4 in. wide, min. depth as indicated under Item 4, spaced a max of 24 in. OC. Studs to be cut 3/8 to 3/4 in. less than assembly height.

2A. **Steel Studs** — (Not Shown — Alternate to Item 2) — For use with Items 5, 5A, 5B, and 5C — Channel shaped, fabricated from min 20 MSG corrosion-protected or galv steel, 3-1/2 in. min depth, spaced a max of 16 in. OC. Studs friction-fit into floor and ceiling runners. Studs to be cut 5/8 to 3/4 in. less than assembly height.

2B. **Framing Members* — Steel Studs** — (Not Shown — Alternate to Item 2) — Proprietary channel shaped steel studs, min depth as indicated under Item 4, spaced a max of 24 in. OC, fabricated from min 0.018 in. thick galv steel. Studs cut 3/8 in. to 3/4 in. less in lengths than assembly heights. Used with Item 1 or corresponding floor and ceiling runner.

CALIFORNIA EXPANDED METAL PRODUCTS CO — Viper20™, Viper X

EB METAL INC — NITROSTUD

IMPERIAL MANUFACTURING GROUP INC — Viper20™

MARINO/WARE, DIV OF WARE INDUSTRIES INC — Viper20™, StudRite™

OLMAR SUPPLY INC — PRIMESTUD

RESCUE METAL FRAMING, L L C — AlphaSTUD

SCAFCO STEEL STUD MANUFACTURING CO — Type SUPREME D24/30EQD and Type SUPREME D20

2C. **Framing Members* — Steel Studs** — (Not Shown — Alternate to Item 2) — Proprietary channel shaped steel studs, min depth as indicated under Item 4, spaced a max of 24 in. OC, fabricated from min 0.015 in. thick galv steel. Studs cut 3/8 in. to 3/4 in. less in lengths than assembly heights. Used with Item 1 or corresponding floor and ceiling runner. For direct attachment of board only.

CALIFORNIA EXPANDED METAL PRODUCTS CO — Viper25™

CLARKDIETRICH BUILDING SYSTEMS — CD ProSTUD

CRACO MFG INC — SmartStud25™

DMFCWBS L L C — ProSTUD

IMPERIAL MANUFACTURING GROUP INC — Viper25™

MARINO/WARE, DIV OF WARE INDUSTRIES INC — Viper25™

SUPER STUD BUILDING PRODUCTS — The Edge

TELLING INDUSTRIES L L C — TRUE-STUD™

3. **Batts and Blankets*** — (As shown in item 4) — Any mineral wool or glass fiber batts, friction fitted between studs and runners. Min. nom thickness as indicated under Item 4. See **Batts and Blankets (BKNV or BZJZ) Categories** for names of Classified companies.

4. **Gypsum Board*** — For 1, 2, 3, and 4 hour ratings when using Items 2, 2A or 2B - Gypsum panels with beveled, square or tapered edges, applied vertically or horizontally. Vertical joints centered over studs and staggered one stud cavity on opposite sides of studs. Vertical joints in adjacent layers (multilayer systems) staggered one stud cavity. Horizontal joints need not be backed by steel framing. Horizontal edge joints and horizontal butt joints on opposite sides of studs need not be staggered. Horizontal edge joints and horizontal butt joints in adjacent layers (multilayer systems) staggered a min of 12 in. In multilayered walls stating vertical or horizontal application, individual layers may be installed either vertically or horizontally as long as the joint locations and screw lengths specified are followed. The thickness and number of layers for the 1 hr, 2 hr, 3 hr and 4 hr ratings are as follows:

Wallboard Protection on Each Side of the Wall with Items 2, 2A or 2B

Rating, hr	Min. Stud Depth, min. (in.)	No. of Layers, Thickness of Panel, Board orientation	Min.Thickness, Density of Insulation (Item 3)	Fastener Schedule (Type S or S-12 screws)
1	2-1/2	1 layer, 1/2 in., vertical only	1-1/2 in., mineral wool, 3 pcf	1 in. long, spaced 8 in. OC along the edges & ends; 12 in. OC in field
1	2-1/2	1 layer, 5/8 in., vertical or horizontal	1-1/2 in., mineral wool, 3 pcf	1 in. long, 8 in. OC along the edges & ends; 12 in. OC in field (Vertical application) 1 in. long spaced 8 in. OC (Horizontal application)
2	2-1/2	2 layers, 1/2 in., vertical only	Optional	1 in. long, 12 in. OC base layer 1-5/8 long, 12 in. OC face layer
2	2-1/2	2 layers, 5/8 in., vertical only	Optional	1 in. long spaced 12 in. OC base layer, 1-5/8 in. long spaced 12 in. OC face layer
2	2-1/2	2 layers, 5/8 in., horizontal only	Optional	1 in. long spaced 16 in. OC base layer, 1-5/8 in. long spaced 16 in. OC face layer
3	1-5/8	3 layers, 1/2 in., 1st and 2nd layer vertical, 3rd layer vertical or horizontal	Optional	1 in. long (1st layer), 1-5/8 in. long (2nd layer), 2-1/4 in. long (3rd layer); with 1-1/2 in. long Type G between studs at horizontal joints in board; spacing 12 in. OC
3	1-5/8	3 layers, 5/8 in., 1st layer, 2nd layer, 3rd layer vertical or horizontal	Optional	1 in. long (1st layer), 1-5/8 in. long (2nd layer), 2-1/4 in. long (3rd layer); with 1-1/2 in. long Type G between studs at horizontal joints in board; spacing 12 in. OC
4	1-5/8	4 layers, 1/2 in., 1st-3rd layers, vertical only, 4th layer, vertical or horizontal	Optional	1 in. long (1st layer), 1-5/8 in. long (2nd layer), 2-1/4 in. long (3rd layer), 2-5/8 in. long (4th layer) with 1-1/2 in. long Type G between studs at horizontal joints in board; spacing 12 in. OC
4	1-5/8	4 layers, 5/8 in., 1st-4th layers, vertical or horizontal	Optional	1 in. long (1st layer), 1-5/8 in. long (2nd layer), 2-1/4 in. long (3rd layer), 2-5/8 in. long (4th layer) with 1-1/2 in. long Type G between studs at horizontal joints in board; spacing 12 in. OC

CERTAINTEE GYPSUM INC — 1/2 in. thick Type C, 5/8 in. thick Type C, Type X-1, Easi-Lite Type X-2, EGRG, GlasRoc, GlasRoc-2, GlasRoc Sheathing Type X, SilentFX

4A. **Gypsum Board*** — (Not Shown — Alternate to Item 4) — **For 1 and 2 hour ratings when using Item 2C** — For 1 hr rating (Vertical application) — Vertical joints are centered over studs and staggered from vertical joints on opposite sides of the wall. For 1 hr rating (Horizontal application) — Horizontal joints need not be staggered on opposite faces or backed by steel framing. For 2 hr rating (Horizontal application) — Two layers of 5/8 in. thick gypsum board applied horizontally. Horizontal joints need not be staggered on opposite faces or backed by steel framing. Face layer horizontal joints must be staggered a minimum 12 in. from the base layer when applied horizontally. For 2 hr rating (Vertical application) - Two layers of 5/8 in. thick gypsum boards applied vertically. Vertical joints are centered over studs and staggered between layers and on opposite sides of the wall. In multilayered walls stating vertical or horizontal application, individual layers may be installed either vertically or horizontally as long as the joint locations and screw lengths specified are followed.

Wallboard Protection on Each Side of the Wall with Item 2C

Rating, hr	Min. Stud Depth, min. (in.)	No. of Layers, Thickness of Panel, Board orientation	Min.Thickness, Density of Insulation (Item 3)	Fastener Schedule (Type S or S-12 screws)
1	3-5/8	1 layer, 5/8 in., vertical or horizontal	Optional	Vertical application - One layer of 5/8 in. thick gypsum board applied vertically with 1 in. long Type-S bugle head screws spaced 8 in. OC at the perimeter and 12 in. OC in the field with the 1st screw installed 4 in. from the board edges at the perimeter and 6 in. from the board edge in the field. Horizontal application - One layer of 5/8 in. thick gypsum board applied horizontally to studs with 1 in. long Type-S bugle head screws spaced 8 in. OC at the perimeter and in the field with the 1st screw installed 4 in. from the board edge.
2	3-5/8	2 layers, 5/8 in., vertical or horizontal	Optional	Horizontal application - Base layer is attached to studs with 1 in. long Type-S bugle head screws, spaced 16 in. OC with 1st and 2nd screws installed 1 in. and 8 in. from board edge, respectively; and to track spaced 16 in. OC. with the 1st screw installed 3 in. from board edge. Face layer attached to studs with 1-5/8 in. long Type S bugle head screws spaced 16 in. OC. with the 1st and 2nd screws installed 1 in. and 8 in. from board edge, respectively; and to track spaced 16 in. OC. with the 1st and 2nd screws installed 2 in. and 11 in. from board edge. Vertical application - Base layer attached to studs with 1 in. long Type-S bugle head screws, spaced 16 in. OC. with 1st screws installed 8 in. from board edge in the field and 3 in. from board edge in the perimeter. Face layer attached to studs with 1-5/8 in. long Type-S bugle head screws, spaced 16 in. OC. with 1st screw installed 16 in. from board edge in the field and 1st and 2st screws installed 2 in. and 11 in. from board edge in the perimeter, respectively.

CERTAINTEE GYPSUM INC — 5/8 in. thick Type C, Type X-1, Easi-Lite Type X-2, EGRG, GlasRoc, GlasRoc-2, GlasRoc Sheathing Type X, SilentFX

5. **Gypsum Board*** — (Not Shown) — As an alternate to Item 4 when used as the base layer on one or both sides of wall when 5/8 in or 3/4 in. thick products are specified. For direct attachment only to steel studs Item 2A, not to be used with Item 3 - Nom 5/8 in. or 3/4 in. may be used as alternate to all 5/8 in. or 3/4 in. shown in Item 5, Wallboard Protection on Each Side of Wall table. Nom 5/8 in. or 3/4 in. thick lead backed gypsum panels with beveled, square or tapered edges, applied vertically. Vertical joints centered over studs and staggered min 1 stud cavity on opposite sides of studs. Gypsum board secured to 20 MSG steel studs Item 2A with 1-1/4 in. long Type S-12 steel screws spaced 8 in. OC at perimeter and 12 in. OC in the field. To be used with Lead Batten Strips (see Item 11) or Lead Discs or Tabs (see Item 12).

RAY-BAR ENGINEERING CORP — Type RB-LBG

5A. **Gypsum Board*** — (Not Shown) — As an alternate to Item 4 when used as the base layer on one or both sides of wall when 5/8 or 3/4 in thick products are specified. For direct attachment only to steel studs Item 2A, not to be used with Item 3 - Nom 5/8 or 3/4 in. may be used as alternate to all 5/8 or 3/4 in. shown in Item 5, Wallboard Protection on Each Side of Wall table. Nom 5/8 or 3/4 in. thick lead backed gypsum panels with beveled, square or tapered edges, applied vertically. Vertical joints centered over 20 MSG steel studs and staggered min 1 stud cavity on opposite sides of studs. Wallboard secured to studs with 1-1/4 in. long Type S-12 steel screws spaced 8 in. OC at perimeter and 12 in. OC in the field. Gypsum board secured to 20 MSG steel studs Item 2B with 1-1/4 in. long Type S-12 steel screws spaced 8 in. OC at perimeter and 12 in. OC in the field. For Joint Compound see Item 5. To be used with Lead Batten Strips (see Item 11A) or Lead Discs (see Item 12A).

MAYCO INDUSTRIES INC — Type X-Ray Shielded Gypsum

5B. **Gypsum Board*** — (Not Shown) — As an alternate to Item 4 when used as the base layer on one or both sides of wall when 1/2 in. or 5/8 in thick products are specified. For direct attachment only to steel studs Item 2A, not to be used with Item 3. Nom 5/8 in. thick lead backed gypsum panels with beveled, square or tapered edges, applied vertically. Vertical joints centered over studs and staggered min 1 stud cavity on opposite sides of studs. Wallboard secured to studs with 1-1/4 in. long Type S-12 steel screws gypsum panel steel screws spaced 8 in. OC at perimeter and 12 in. OC in the field. Lead batten strips required behind vertical joints of lead backed gypsum wallboard and optional at remaining stud locations. Lead batten strips, min 2 in. wide, max 8 ft long with a max thickness of 0.14 in. placed on the face of studs and attached to the stud with construction adhesive and two 1 in. long Type S-12 pan head steel screws, one at the top of the strip and one at the bottom of the strip. Lead discs, nominal 3/8 in. diam by max 0.085 in. thick. Compression fitted or adhered over the screw heads. Lead batten strips and discs to have a purity of 99.9% meeting the Federal specification QQ-L-201F, Grade "C".

RADIATION PROTECTION PRODUCTS INC — Type RPP - Lead Lined Drywall

5C. **Gypsum Board*** — (Not Shown) — As an alternate to Item 5 when used as the base layer on one or both sides of wall when 1/2 in. or 5/8 in thick products are specified. For direct attachment only to steel studs Item 2A, not to be used with Item 3. Nominal 5/8 in. thick lead backed gypsum panels with beveled, square or tapered edges, applied vertically. Vertical joints centered over studs and staggered min 1 stud cavity on opposite sides of studs. Wallboard secured to studs with 1-1/4 in. long Type S-12 (or No. 6 by 1-1/4 in. long bugle head fine driller) steel screws spaced 8 in. OC at perimeter and 12 in. OC in the field.

NEW ENGLAND LEAD BURNING CO INC, DBA NELCO — Nelco

5D. **Gypsum Board*** — (As an alternate to Item 5, for 1 hr. rating) — Nom. 5/8 in. thick gypsum panels applied vertically or horizontally. Horizontal edge joints and horizontal butt joints on opposite sides of studs need not be staggered or backed by steel framing. Gypsum panels fastened to framing with 1 in. long Type 5 steel screws 12 in. OC along vertical edges and in the field. Screws spaced a max 12 in. along the top and bottom edges of the wall for both vertical and horizontal applications.

CERTAINTEE GYPSUM INC — Type X-1, SilentFX, GlasRoc, Type C

6. **Furring Channels** — (Optional, not shown, for single or double layer systems only) — Resilient furring channels fabricated from min 25 MSG corrosion-protected steel, spaced vertically a max of 24 in. OC. Flange portion attached to each intersecting stud with 1/2 in. long Type S-12 steel screws.

6A. **Framing Members*** — (Optional on one or both sides, not shown, for single or double layer systems) — As an alternate to Item 6, furring channels and Steel Framing Members as described below:

a. **Furring Channels** — Formed of No. 25 MSG galv steel, 2-9/16 in. or 2-23/32 in. wide by 7/8 in. deep, spaced max. 24 in. OC perpendicular to studs. Channels secured to studs as described in Item b. Gypsum board attached to furring channels as described in Item 5. Not for use with Item 5, 5A, 5B or 5C.

b. **Steel Framing Members*** — Used to attach furring channels (Item 6Aa) to studs (Item 2). Clips spaced max. 48 in. OC. RSIC-1 and RSIC-1 (2.75) clips secured to studs with No. 8 x 1-1/2 in. minimum self-drilling, S-12 steel screw through the center grommet. RSIC-V and RSIC-V (2.75) clips secured to studs with No. 8 x 9/16 in. minimum self-drilling, S-12 steel screw through the center hole. Furring channels are friction fitted into clips. RSIC-1 and RSIC-V clips for use with 2-9/16 in. wide furring channels. RSIC-1 (2.75) and RSIC-V (2.75) clips for use with 2-23/32 in. wide furring channels.

PAC INTERNATIONAL L L C — Types RSIC-1, RSIC-1 (2.75)

6B. **Framing Members*** — (Optional on one or both sides, not shown, for single or double layer systems) — As an alternate to Item 6 and 6A, furring channels and Steel Framing Members as described below:

a. **Furring Channels** — Formed of No. 25 MSG galv steel, 2-5/8 in. wide by 7/8 in. deep, spaced 24 in. OC perpendicular to studs. Channels secured to studs as described in Item b. Ends of adjoining channels overlapped 6 in. and tied together with double strand of No. 18 AWG galvanized steel wire. Gypsum board attached to furring channels as described in Item 5. Not for use with Item 5, 5A, 5B or 5C.

b. **Steel Framing Members*** — Used to attach furring channels (Item 6Ba) to studs (Item 2). Clips spaced 48 in. OC, and secured to studs with 2 in. coarse drywall screw with 1 in. diam washer through the center hole. Furring channels are friction fitted into clips.

STUDCO BUILDING SYSTEMS — RESILMOUNT Sound Isolation Clips - Type A237R

6C. **Steel Framing Members*** — (Optional on one or both sides, not shown, for single or double layer systems.) (Optional, Not Shown) — Furring channels and Steel Framing Members as described below:

a. **Furring Channels** — Formed of No. 25 MSG galv steel, spaced 24 in. OC, and perpendicular to studs. Channels secured to studs as described in Item b. Ends of adjoining channels overlapped 6 in. and secured in place with a double strand of No. 18 AWG twisted steel wire. Gypsum board attached to furring channels as described in Item 5. Not for use with Item 5, 5A, 5B, or 5C.

b. **Steel Framing Members*** — Used to attach furring channels (Item 6Ca) to studs (Item 2). Clips spaced 48 in. OC, and secured to studs with No. 8 x 2-1/2 in. coarse drywall screw through the center hole. Furring channels are friction fitted into clips.

REGUPOL AMERICA — Type SonusClip

6D. **Steel Framing Members*** — (Optional on one or both sides, not shown, for single or double layer systems.) (Optional, Not Shown) — Resilient channels and Steel Framing Members as described below:

a. **Resilient Channels** — Formed of No. 25 MSG galv steel, spaced 24 in. OC, and perpendicular to studs. Channels secured to studs as described in Item b. Ends of adjoining channels overlapped 6 in. and secured in place with two No. 8 15 x 1/2 in. Philips Modified Truss screws spaced 2-1/2 in. from the center of the overlap. Gypsum board attached to resilient channels as described in Item 5. Not for use with Item 5, 5A, 5B, or 5C.

b. **Steel Framing Members*** — Used to attach resilient channels (Item 6Da) to studs (Item 2). Clips spaced 48 in. OC, and secured to studs with No. 8 x 2-1/2 in. coarse drywall screw through the center hole. Resilient channels are secured to clips with one No. 10 x 1/2 in. pan-head self-drilling screw.

KEENE BUILDING PRODUCTS CO INC — Type RC+ Assurance Clip

7. **Joint Tape and Compound** — Vinyl or casein, dry or premixed joint compound applied in two coats to joints and screw heads of outer layers. Paper tape, nom 2 in. wide, embedded in first layer of compound over all joints of outer layer panels. Paper tape and joint compound may be omitted when gypsum panels are supplied with a square edge.

8. **Siding, Brick or Stucco** — (Optional, Not Shown) — Aluminum, vinyl or steel siding, brick veneer or stucco, meeting the requirements of local code agencies, installed over gypsum panels. Brick veneer attached to studs with corrugated metal wall ties attached to each stud with steel screws, not more than each sixth course of brick.

9. **Caulking and Sealants*** — (Optional, Not Shown) — A bead of acoustical sealant applied around the partition perimeter for sound control.

10. **Lead Batten Strips** — (Not Shown — For Use With Item 5) — Lead batten strips, min 1-1/2 in. wide, max 10 ft long with a max thickness of 0.125 in. Strips placed on the interior face of studs and attached from the exterior face of the stud with two 1 in. long Type S-12 pan head steel screws, one at the top of the strip and one at the bottom of the strip. Lead batten strips to have a purity of 99.9% meeting the Federal specification QQ-L-201f, Grade "C". Lead batten strips required behind vertical joints of lead backed gypsum wallboard (Item 5) and optional at remaining stud locations. Required behind vertical joints.

10A. **Lead Batten Strips** — (Not Shown — For Use With Item 5A) — Lead batten strips, 2 in. wide, max 10 ft long with a max thickness of 0.140 in. Strips placed on the face of studs and attached to the stud with two min. 1 in. long min. Type S-8 pan head steel screws, one at the top of the strip and one at the bottom of the strip or with one min. 1 in. long min. Type S-8 pan head steel screw at the top of the strip. Lead batten strips to have a purity of 99.5% meeting the Federal specification QQ-L-201f, Grades "B, C or D". Lead batten strips required behind vertical joints of lead backed gypsum wallboard and optional at remaining stud locations.

11. **Lead Discs or Tabs** — (Not Shown, For Use With Item 5) — Used in lieu of or in addition to the lead batten strips (Item 11) or optional at other locations - Max 3/4 in. diam by max 0.125 in. thick lead discs compression fitted or adhered over steel screw heads or max 1/2 in. by 1-1/4 in. by max 0.125 in. thick lead tabs placed on gypsum boards (Item 5) underneath screw locations prior to the installation of the screws. Lead discs or tabs to have a purity of 99.9% meeting the Federal specification QQ-L-201f, Grade "C".

11A. **Lead Discs** — (Not Shown, for use with Item 5A) — Max 5/16 in. diam by max 0.140 in. thick lead discs compression fitted or adhered over steel screw heads. Lead discs to have a purity of 99.5% meeting the Federal Specification QQ-L-201f, Grades "B, C or D".

12. **Lead Batten Strips** — (Not Shown — For Use With Item 5C) — Lead batten strips, 2 in. wide, max 10 ft long with a max thickness of 0.142 in. Strips placed on the face of studs and attached to the stud with two min. 1 in. long min. Type S-8 pan head steel screws, one at the top of the strip and one at the bottom of the strip or with one min. 1 in. long min. Type S-8 pan head steel screw at the top of the strip. Lead batten strips to have a purity of 99.9% meeting the Federal specification QQ-L-201f, Grade "C". Lead batten strips required behind vertical joints of lead backed gypsum wallboard (Item 5E) and optional at remaining stud locations.

13. **Lead Tabs** — (Not Shown — For Use With Item 5C) — 2 in. wide, 5 in. long with a max thickness of 0.142 in. Tabs friction-fit around front face of stud, the stud folded back flange, and the back face of the stud. Tabs required at each location where a screw (that secures the gypsum boards, Item 5E) will penetrate the steel stud. Lead tabs to have a purity of 99.9% meeting the Federal specification QQ-L-201f, Grade "C". Lead tabs may be held in place with standard adhesive tape if necessary.

14. **Barrier Mesh** — (Optional, Not Shown) - Attached to steel studs on one or both sides of the wall using Barrier Mesh Clips spaced at maximum 12 inches on center vertically, using a flat head type screw penetrating through the steel at least 3/8 of an inch. For Steel Studs less than 0.033 inches in thickness, use self-piercing screws. For Steel Studs equal to or greater than 0.033 inches in thickness, use steel drill screws (self-tapping). Gypsum Board (Item 4) to be installed directly over the Barrier Mesh using prescribed screw patterns with lengths increased by a minimum 1/8 in. Barrier Mesh may be installed with the long dimension of the diamond pattern positioned vertically or horizontally. Barrier Mesh joints may occur as butt joints at the framing members and secured using the Barrier Mesh Clips or occur in between framing members as overlapping joints secured using 18 SWG wire ties spaced a maximum 12 in. on center.

CLARSDIETRICH BUILDING SYSTEMS — Barrier Mesh, Barrier Mesh Clips

* Indicates such products shall bear the UL or cUL Certification Mark for jurisdictions employing the UL or cUL Certification (such as Canada), respectively.

Last Updated on 2022-05-25

The appearance of a company's name or product in this database does not in itself assure that products so identified have been manufactured under UL's Follow-Up Service. Only those products bearing the UL Mark should be considered to be Certified and covered under UL's Follow-Up Service. Always look for the Mark on the product.

UL permits the reproduction of the material contained in the Online Certification Directory subject to the following conditions: 1. The Guide Information, Assemblies, Constructions, Designs, Systems, and/or Certifications (files) must be presented in their entirety and in a non-misleading manner, without any manipulation of the data (or drawings). 2. The statement "Reprinted from the Online Certifications Directory with permission from UL" must appear adjacent to the extracted material. In addition, the reprinted material must include a copyright notice in the following format: "© 2022 UL LLC"