



Expanding Your Solutions

Corporate Headquarters
13191 Crossroads Pkwy N., Ste 325
City of Industry, CA 91746
Phone: 800.775.2362
Fax: 626.330.7598

Manufacturing Facilities
City of Industry, CA
Commerce City, CO
Ft. Worth, TX
Pittsburg, CA

Structural Engineering/Design
1001-A Pittsburgh Antioch Hwy
Pittsburg, CA 94565
Phone: 800.775.2362
Fax: 626.330.7598

Technical Services
13191 Crossroads Pkwy N., Ste 325
City of Industry, CA 91746
Phone: 800.416.2278
Fax: 626.249.5004

SURE-BOARD SERIES 200B

Geometric Properties

Sure-Board® Series 200B for Blast is an enhanced version of 200, used in pre-tested assemblies for varying degrees of Blast protection.

Steel Thickness

Panel Type	Length A (ft.)	Width B (ft.)	Sheathing Type	Sheathing Thickness (in.)	Steel Thickness Gauge (mil.)
Series 200BI (Interior Blast Resistant Panels)	8	48	Type "X" or Type "C" fire rated gypsum board, water resistant core sheathing, fiber reinforced cement board	1/2, 5/8 or 3/4	22 (27)
Series 200BX (Exterior Blast Resistant Panels)	8	48		1/2, 5/8 or 3/4	14 (68)

Notes:

1. Requests for a specific brand of gypsum drywall must be made at the time of order.
2. Ordering certain specialty non-stock gypsum/cement board products, may result in extended lead-times.

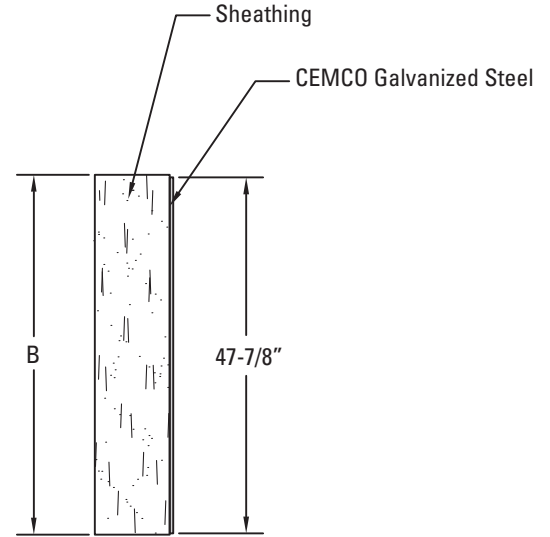

Sure-Board Side View

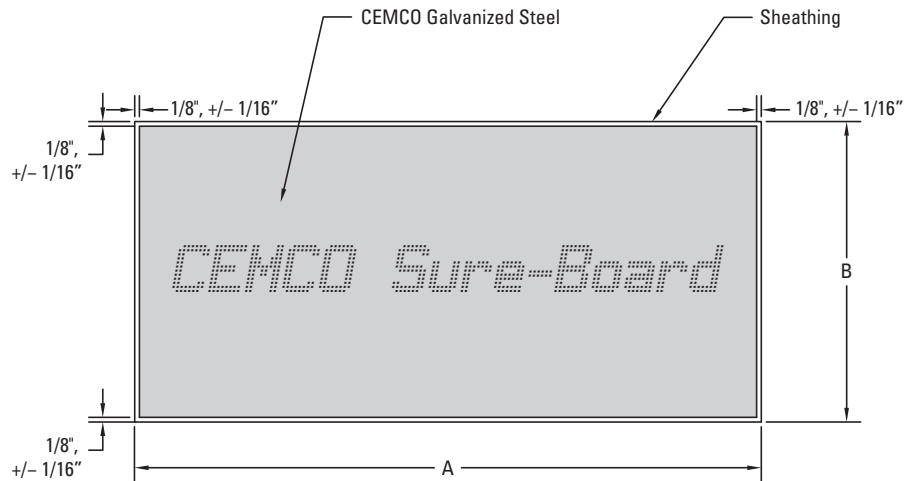

ASTM & Code Standards:

- ASTM A653/653M, A924/924M & A1003/1003M (Steel)
- ASTM C1325 (Cement Board)
- IBC 2018 & 2021
- IRC 2018 & 2021
- CBC 2019
- IAPMO ER-126 & 185
- DSA Approved IR A-5

CEMCO cold-formed steel framing products recycled steel:

- Total Recycled Content: 36.9%
- Post-Consumer: 19.8%
- Pre-Consumer: 14.4%

LEED v4 for Building and Design Construction:

- MR Prerequisite: Construction and Demolition Waste Management Planning.
- MR Credit: Construction and Demolition Waste Management.
- MR Credit: Building Product Disclosure and Optimization – Sourcing of Raw Materials, Option 2.
- MR Credit: Building Product Disclosure and Optimization – Environmental Product Declarations, Options 1 & 2.
- MR Credit: Building Product Disclosure and Optimization – Material Ingredients, Option 1.
- MR Credit: Building Life-Cycle Impact Reduction, Option 4.

Technical Services

Technical Services: 800.416.2278
Structural Engineering/Design: 925.473.9340
www.cemcosteel.com



This technical information reflects the most current information available and supersedes any and all previous publications effective January 23, 2025.

01-23-25 AT